

# AGENDA MAP

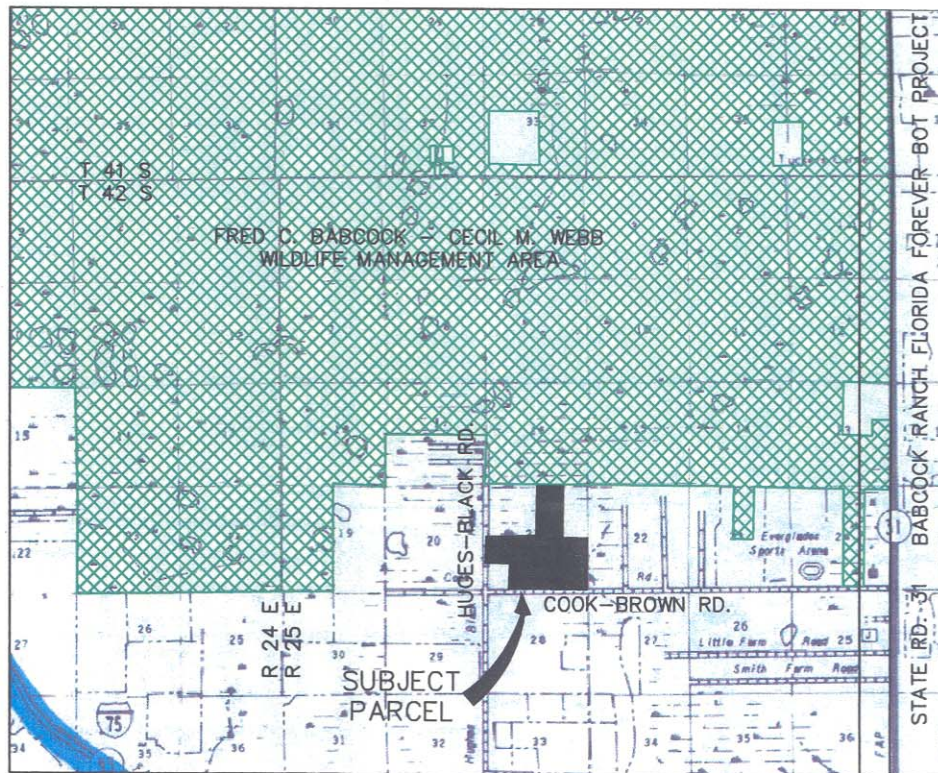

NOT TO SCALE

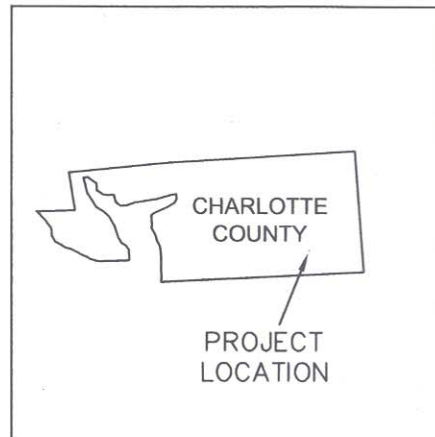

**LEGEND:**

- FLORIDA FOREVER BOT PROJECT BOUNDARY
- STATE OWNED LAND
- SUBJECT PARCEL

*THIS IS NOT A SURVEY*

**JEFFREY C. COONER AND ASSOCIATES, INC.**

SURVEYING AND MAPPING  
3900 COLONIAL BLVD., SUITE 4, FORT MYERS, FLORIDA 33912  
PHONE: (239)277-0722 FAX: (239)277-7179 EMAIL: SURVEYING@COONER.COM

FFWCC ADDITION AND INHOLDING, BABCOCK WEBB WMA  
USDA / SMITH PARCEL, OFFICE FILE # 985.116  
TASK ASSIGNMENT NUMBER: FFWCC-1  
SECTION 21, TOWNSHIP 42 SOUTH, RANGE 25 EAST

COUNTY:	CHARLOTTE	DWG DATE:	10.20.04
SEC.:	21-42-25	SURVEY DATE:	N/A
PROJECT NO.:	040502.1	DRAWN BY:	DKT
DRAWING NO.:	04050201-APM	CHECKED BY:	JCC

FOR:  
DEPT. OF ENVIRONMENTAL PROTECTION  
BUREAU OF SURVEYING AND MAPPING  
3900 COMMONWEALTH BLVD. TALLAHASSEE, FL 32399