

Special-Opportunity
Dove Field

**2009-
2010**
Hunting
Season

North Newberry

Public Small Game Hunting Area

Regulations Summary and Area Map
July 1, 2009 - June 30, 2010

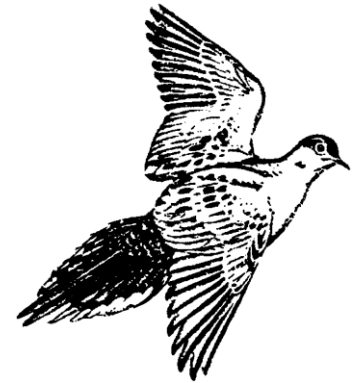

A public small game hunting area



Florida Fish and Wildlife
Conservation Commission

MyFWC.com

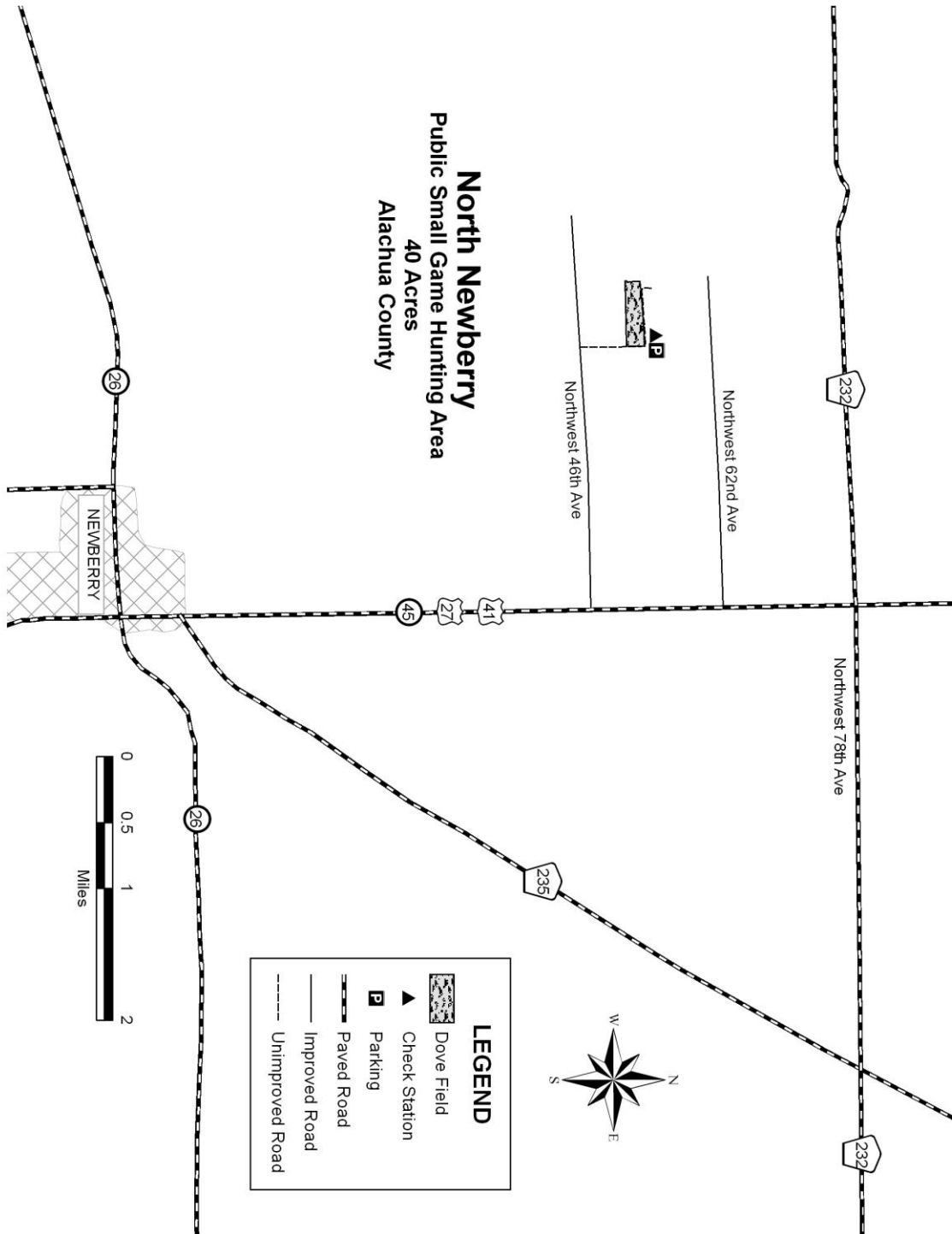

North Newberry
Public Small Game Hunting Area
40 Acres
Alachua County

LEGEND

- Dove Field
- Check Station
- Parking
- Paved Road
- Improved Road
- Unimproved Road

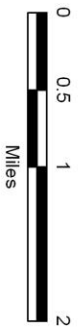

This brochure is designed to provide the public with information and a summary of regulations pertaining to hunting and other recreational use on the North Newberry Public Small Game Hunting Area. **Regulations that are new or differ substantially from last year are shown in bold print.** Area users should familiarize themselves with all regulations. For exact wording of the wildlife laws and regulations, see the Florida Fish and Wildlife Conservation Commission's wildlife code, on file with the Secretary of State and state libraries. This brochure and the Florida Hunting Regulations handbook should provide the information necessary for you to plan your hunting activities. These publications are available from any Commission office, county tax collector and at MyFWC.com.

PERMIT, STAMP AND LICENSE INFORMATION:

Persons using Public Small Game Hunting Areas are required to have appropriate licenses, permits and stamps. The following persons are exempt from all license and permit requirements (except for quota permits when listed as "no exemptions", and the Migratory Bird Hunting and Conservation Stamp [federal duck stamp]): Florida residents who are 65 years of age or older; residents who possess a Florida Resident Disabled Person Hunting and Fishing Certificate; residents in the U.S. Armed Forces, not stationed in Florida, while home on leave for 30 days or less, upon submission of orders; and children under 16 years of age. Children under 16 years of age are exempt from the federal duck stamp.

Hunting, trapping and fishing licenses, and management area and state waterfowl permits may be purchased from county tax collectors, license agents, at MyFWC.com/license or by telephone at 1-888-486-8356. A no-cost Migratory Bird Permit is available when purchasing a hunting license.

QUOTA PERMIT INFORMATION:

Dove Hunt - 25, special-opportunity (no exemptions) for each of 8 hunts.

Annual Dove Club permits, which allow the permit holder to hunt all scheduled hunts for a particular field, are available beginning July 1, 10 a.m. EST and may be purchased anywhere licenses are sold until September 9, 11:59 p.m. EST. This permit costs \$150 and is non-transferable and non-refundable; it also allows the adult permit holder and a youth, under the age of 16, to hunt together and for each to harvest a daily bag limit of birds. Regular and Combination (youth/adult) permits will be available for each hunt on a first-come, first-served basis beginning September 17, 10 a.m. EST. Each permit will be valid for one day only. Regular (\$35.50) and Combination (\$45.50) permits may be purchased anywhere licenses are sold. A Regular Permit allows an adult, or an adult and a youth, under the age of 16, to hunt together; however, it allows only one daily bag limit of birds to be

harvested between the two. A Combination Permit allows an adult and youth, under the age of 16, to hunt together and for each to harvest a daily bag limit of birds. If you purchase a Regular or Combination permit but later decide not to use it, you can transfer it to another hunter. Lifetime license holders that purchased their license before July 1, 1998 can acquire a free permit (only one permit, per hunt, per license holder). However, these free permits may only be transferred to individuals with a valid Lifetime hunting license purchased before July 1, 1998.

GENERAL REGULATIONS:

In addition to the regulations that follow, all general laws and regulations relating to wild animal life shall apply, unless specifically exempted for this area.

1. Dove hunting shall be allowed only within the posted dove field.
2. Permitted hunters are allowed to inspect the field without a firearm on the day they are scheduled to hunt. Hunters may request that their permit be voided by the hunt headquarters operator, provided they have not entered the field with a firearm, and may receive a refund by submitting their voided permit and a refund request certified by the hunt headquarters operator to the Florida Fish and Wildlife Conservation Commission, 620 South Meridian Street, Tallahassee, Florida 32399-1600.
3. Hunters must pick up all shotgun shells and other trash before leaving the dove field.

PUBLIC ACCESS AND VEHICLES:

1. Public access within the dove field is prohibited except by special-opportunity dove hunt permit holders and their guests only, and only on their scheduled hunt dates and times. Access at any other time is prohibited.
2. Dove hunters may enter the area no earlier than 11 a.m. and shall exit the area no later than one hour after sunset.
3. All vehicles must park in the designated parking area(s).

HUNTERS AND CHECK STATIONS:

1. Dove hunters shall check in and out at the designated dove field check station when entering or exiting the area and check all game taken.
2. Each permitted hunter may be accompanied by one (1) non-hunting guest. The non-hunting guest shall remain under the supervision and in the presence of the permitted hunter at all times during the hunt.

GUNS:

1. Hunting with firearms other than shotguns is prohibited.
2. Shotguns shall not be larger than 10 gauge and shall be incapable of holding more than three shells in the magazine and chamber combined.
3. Children under the age of 16 may not be in possession of a firearm unless in the presence of a supervising adult.

DOGS:

Any waterfowl retriever or bird dog may be used to find downed or crippled birds. You also may use other breeds of dog with a shoulder height of 17 inches or less.

BAG AND POSSESSION LIMITS: Aggregate of mourning and white-winged dove - Daily limit 15. Eurasian collared-dove and rock dove - no limit. Only one daily bag limit may be possessed while in the field or while returning from the field. Hunters may leave their birds with another person if the birds are tagged with the hunter's signature and address, the total number of birds, by species, and the date birds were harvested.

DOVE HUNT:

October 3, 10 and 24, November 14 and 28, December 12 and 26 and January 9.

Permit, Stamp and License Requirements - Special-opportunity dove hunting permit, hunting license and migratory bird permit.

Legal to Take - Eurasian collared-dove, mourning dove, rock dove (common pigeon) and white-winged dove only.

Shooting hours - Noon until sunset.

DIRECTIONS TO THE HUNTING AREA:

The North Newberry Special-Opportunity dove field is located approximately 4 miles north of Newberry in Alachua County (see map). From the intersection of US 41 and SR 26 in Newberry, travel north on US 41 for 3.6 miles until you come to Northwest 46th Avenue on the left. Turn left on Northwest 46th Avenue and travel 2.0 miles to a drive on the right (north side of road) that leads to the check station and dove field (0.5 miles north of Northwest 46th Avenue).

DOVE HUNTERS HOTLINE:

Visit our web site at www.myfwc.com/special/dove/ to find out the latest information on FWC dove fields across the state of Florida. Most of the information will be updated every Thursday throughout the dove season.

When you spot law violators or suspicious activities, contact your nearest Commission regional office or call 1-888-404-FWCC. You may qualify for a cash reward from the Wildlife Alert Reward Association.

This agency and the U.S. Department of the Interior prohibit discrimination by race, color, nationality, age, sex or handicap. If you believe you have been discriminated against in any program, activity or facility of this agency, write to: Florida Fish and Wildlife Conservation Commission, 620 South Meridian Street, Tallahassee, FL 32399-1600 or to: Office of Human Relations, USFWS, Department of the Interior, Washington, D.C. 20240.